

Remove back cover / battery cover

1. Loosen the screw in the proper direction to open the back cover as pictured below. It will give you access to the clock's controls and two (2) battery slots.

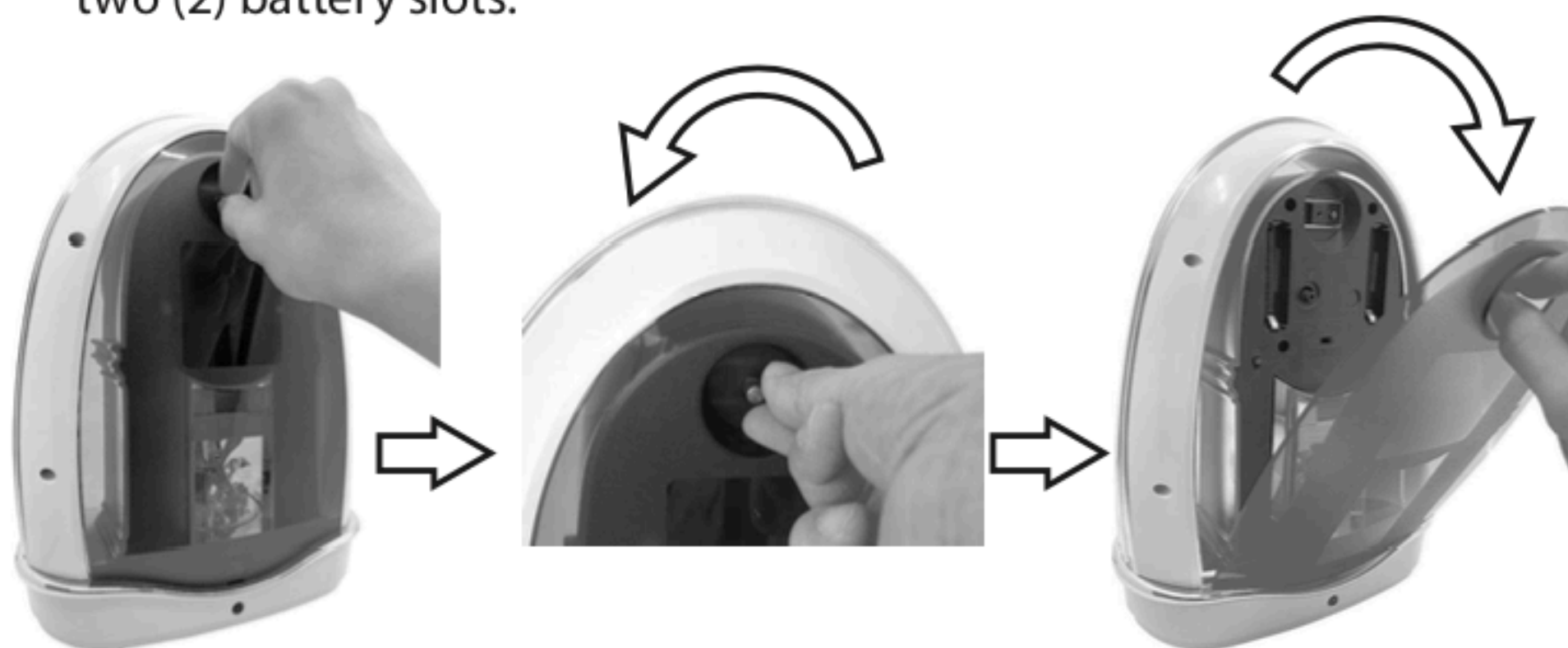

2. Remove the battery cover at the bottom of the clock.



3. Insert all six (6) AA batteries according to (+) and (-) markings in the battery compartment.

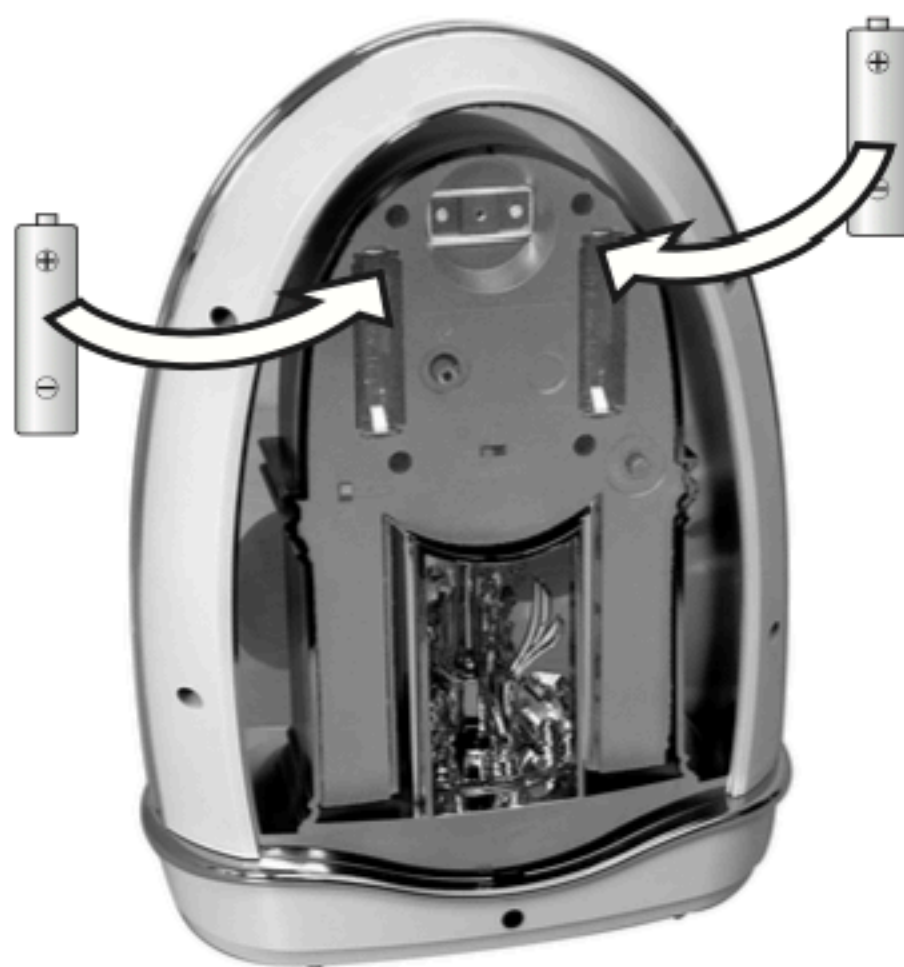

4. Adjust the time, volume, and melody selection before replacing the back cover.